

# COMMUNITY ROOM SET UP DIAGRAM FOR RENTALS

Dimensions of Room: 64' x 30'

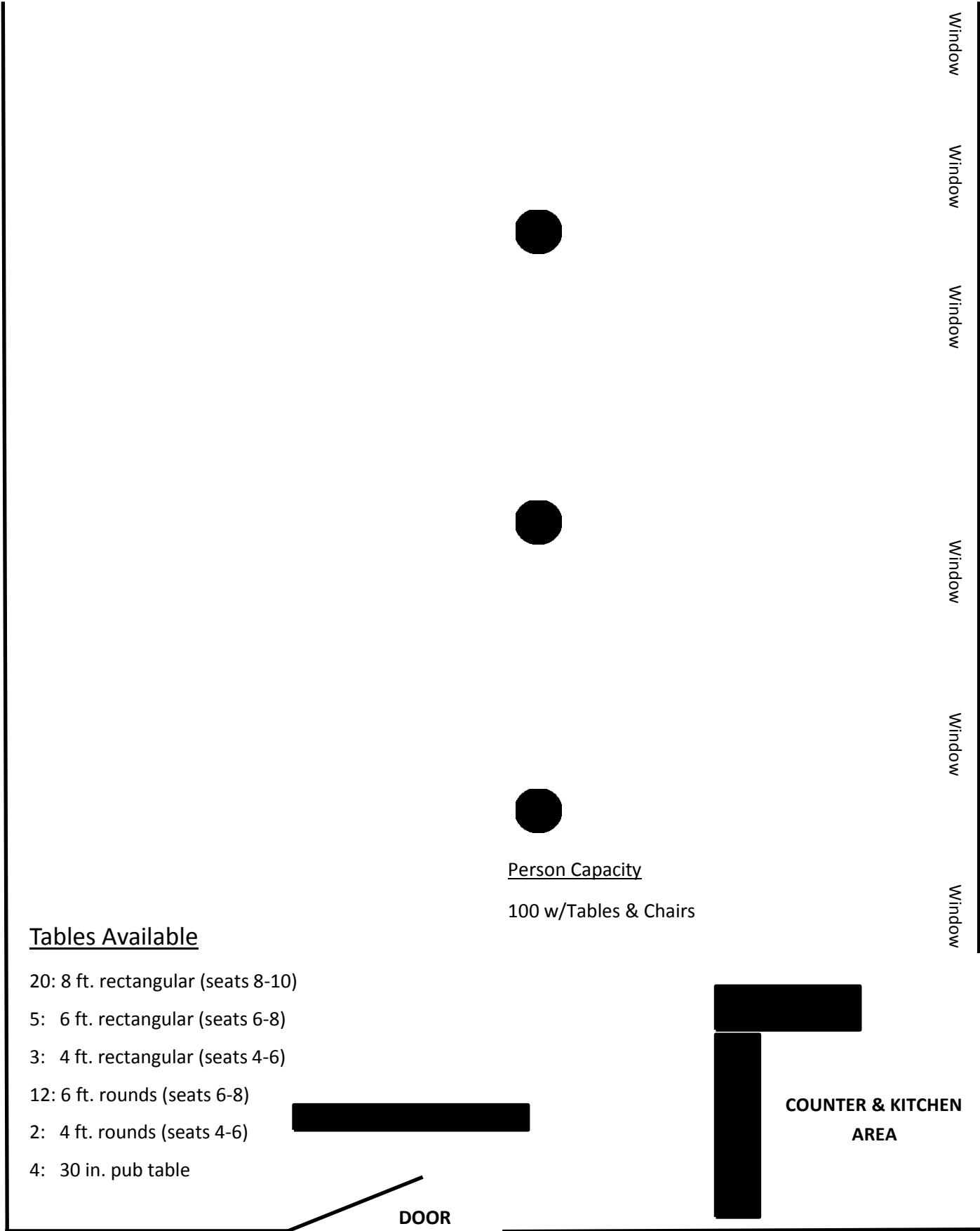
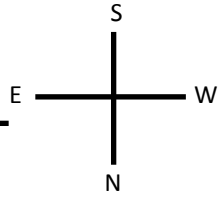

Person Capacity  
100 w/Tables & Chairs

### Tables Available

- 20: 8 ft. rectangular (seats 8-10)
- 5: 6 ft. rectangular (seats 6-8)
- 3: 4 ft. rectangular (seats 4-6)
- 12: 6 ft. rounds (seats 6-8)
- 2: 4 ft. rounds (seats 4-6)
- 4: 30 in. pub table



**COUNTER & KITCHEN  
AREA**

