



Local Public Agency	County	Section Number
Village of Palos Park	Cook	

The following Special Provision supplement the "Standard Specifications for Road and Bridge Construction", adopted January 1, 2024, the latest edition of the "Manual on Uniform Traffic Control Devices for Streets and Highways", and the "Manual of Test Procedures of Materials" in effect on the date of invitation of bids, and the Supplemental Specification and Recurring Special Provisions indicated on the Check Sheet included here in which apply to and govern the construction of the above named section, and in case of conflict with any parts, or parts of said Specifications, the said Special Provisions shall take precedence and shall govern.

1. 89th Avenue from 123rd Street north to the dead end
2. 90th Avenue from 121st Street north to the dead end
3. Hobart Avenue from 123rd Street south to the dead end
4. 85th Avenue from 119th Street north to the dead end
5. 119th Place form 86th Avenue east to the dead end
6. 87th Avenue from 121st Street to 123rd Street
7. Elm Street from 123rd Street north to the dead end
8. 124th Street from Elm Street to 91st Avenue
9. 125th Street from 91st Street west to the dead end
10. 91st Street from Forest Glen to 126th Street
11. 126th Street from Southwest Highway west to the dead end
12. 89th Avenue from Ridge Avenue to 126th Street
13. Ridge Avenue from 88th Avenue to Rosewood
14. Timberlane Drive from 127th Street north to the dead end
15. Regina Lane from 127th Street north to the dead end
16. Highwood Drive from 118th to Route 83
17. 83rd Avenue from 118th to Kimber
18. 82nd Court from 118th to Kimber
19. 118th Street from 82nd Avenue to Highwood Drive
20. 82nd Avenue from 119th to 118th
21. Kimber Lane from Highwood to Route 83
22. Romiga Lane form Wolf Road to Wildwood Trail
23. Old Timber Lane from Romiga to Sunnyslope
24. Wildwood Trail from Romiga to Sunnyslope
25. Sunnyslope from Old Timber west to the dead end
26. Huntleigh Road from Wolf Road to Sunnyslope Road



to Road
 a Station

- AUTOBAIN DR S
- BLACK FOREST LN
- BLACK WALNUT TRL
- BROOK LN
- BROOKSIDE CT
- BROOKSIDE DR
- CALUMET SAG RD
- CHEROKEE RD
- COMMONS DR
- CREEK RD
- DDEERPATH LN
- EDELWEISS DR
- ELBRIDGE AVE
- HILL CREEK DR
- HILLCREST LN
- HILLSIDE CIR
- HOBART AVE
- HOLMES AVE
- IROQUOIS RD
- KIMBER LN
- KINARRA DR
- KNOXWOOD DR
- LAGRANGE RD
- LAKELAND AVE
- LAKEWOOD AVE
- LANGDON LN
- MCCORD TRACE
- MCKINLEY AVE
- MEMORIAL DR
- MILL RD
- MCHAWK RD
- OAK RIDGE DR
- OLD PRAGUE PATH
- PALOS AVE
- PARKLANE DR
- PAVINEE RD
- REGINA LN
- RIDGE AVE
- ROMA RD
- SOMERSET LN
- SOUTHWEST HWY
- SPRING DR
- TIMBERLANE DR
- TIMBER LN
- VIENNA AVE
- WALNUT RIDGE DR
- WILD CHERRY LN
- WINDSOR DR
- WOODLAND TRL
- S. WOODLAND TRL
- M5
- P5-P7 Q4
- Q5 R4 S2-S3
- P3
- T5
- S2 S3
- S1
- R1 R2
- N5 M5
- M5
- M5
- Q5
- Q5
- P5
- O3 P4
- R3 R4
- R5
- O2-O4
- R4 R5
- R1 S1
- M5
- S3 S4
- L6-N6
- R4
- P2
- T5
- S2
- M5 N6
- S3
- S2
- Q1 R1
- S1 S2
- R4
- S3 S4
- L6-N6
- R4
- P2
- Q1

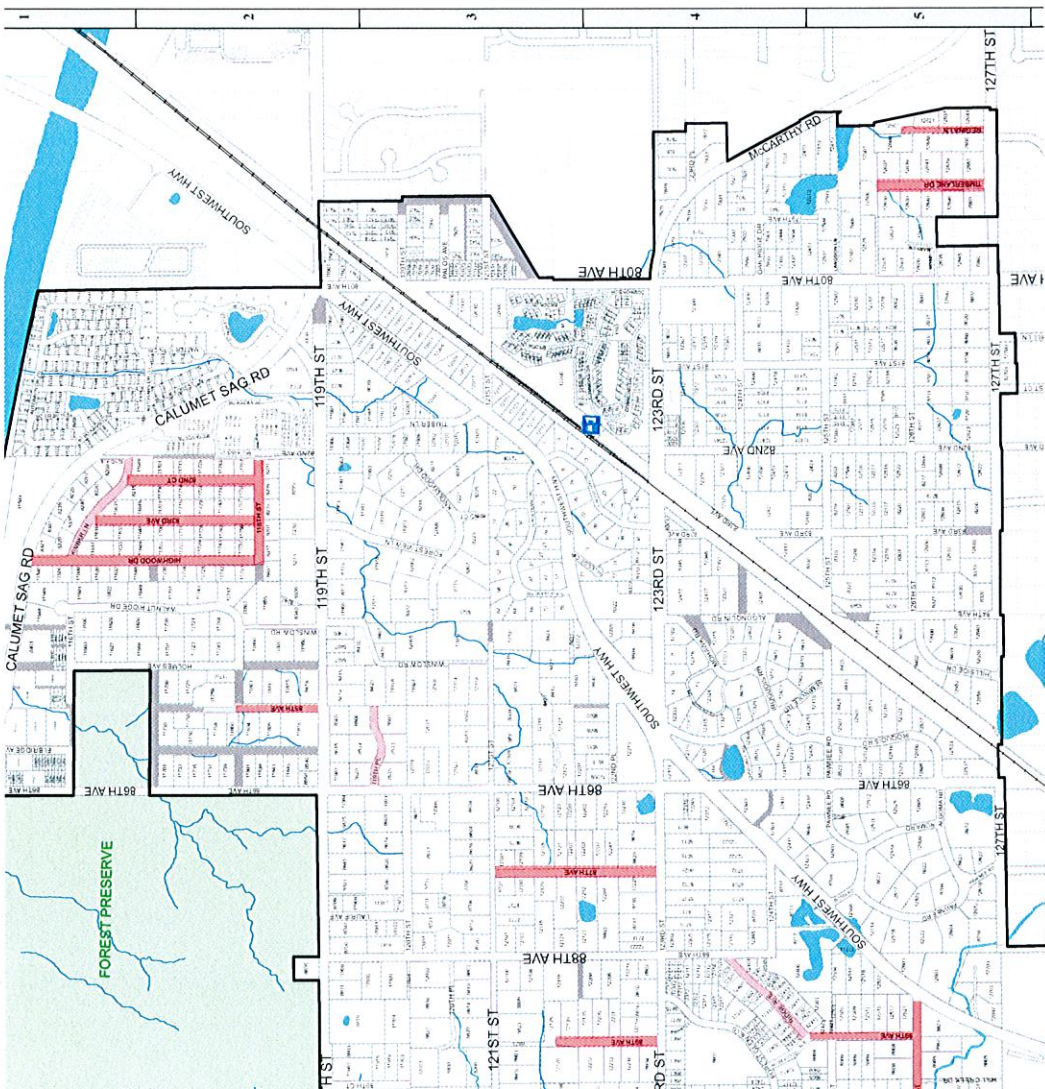

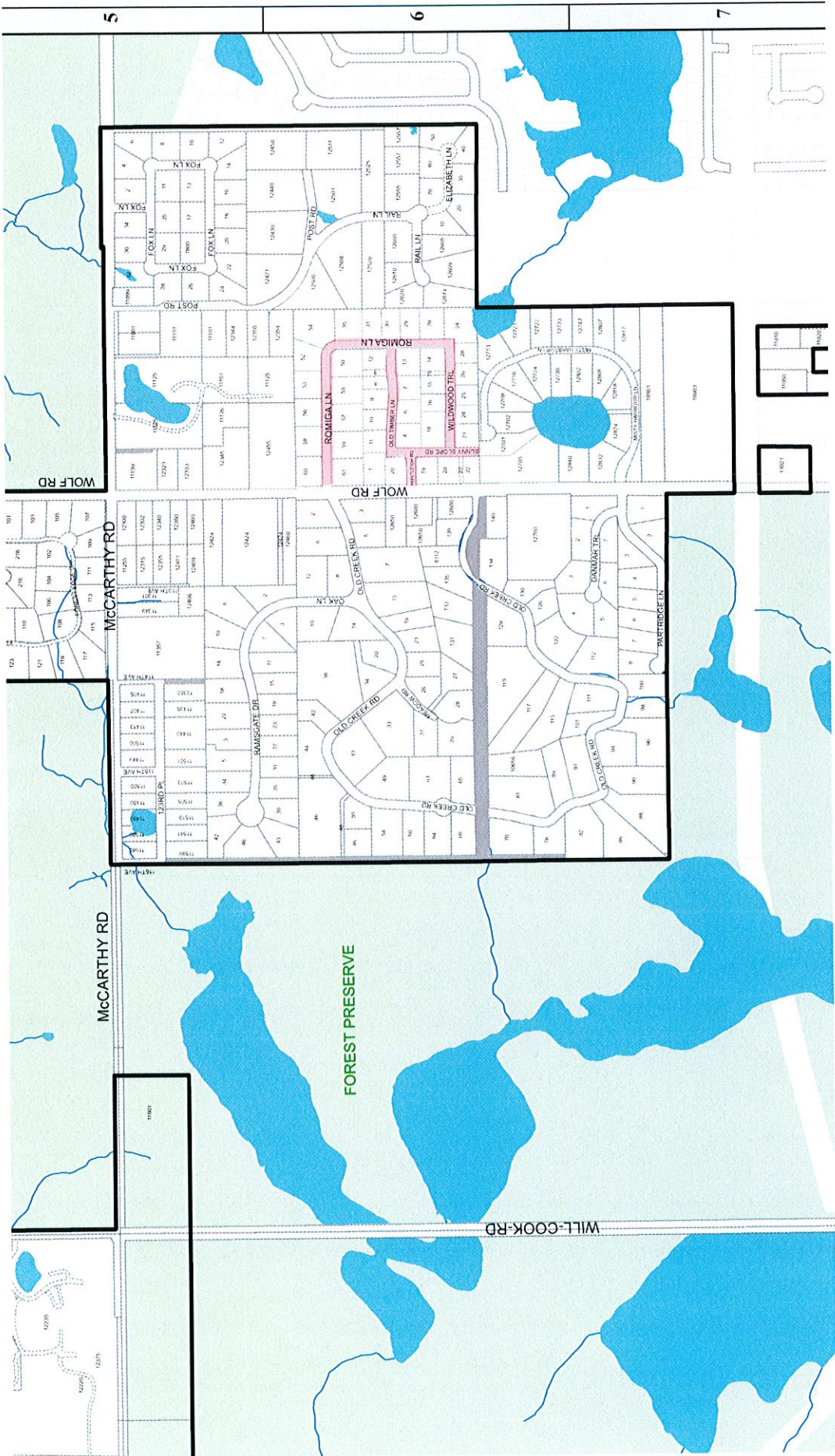

5

6

7

WOLF RD

MCCARTHY RD

WOLF RD

WOLF RD

WOLF RD

WOLF RD

WOLF RD

WOLF RD

WOLF RD

WOLF RD

WOLF RD

WOLF RD

WOLF RD

WOLF RD

WOLF RD

WOLF RD

WOLF RD

WOLF RD

WOLF RD

WOLF RD

WOLF RD

WOLF RD

WOLF RD

WOLF RD

WOLF RD

WOLF RD

WOLF RD

WOLF RD

WOLF RD

WOLF RD

WOLF RD

WOLF RD

WOLF RD

WOLF RD

FOREST PRESERVE

MCCARTHY RD

WILL-COOK RD

OLD CREEK RD

OLD CREEK RD

OLD CREEK RD

OLD CREEK RD

OLD CREEK RD

OLD CREEK RD

OLD CREEK RD

OLD CREEK RD

OLD CREEK RD

OLD CREEK RD

RAMSGATE DR

RAMSGATE DR

RAMSGATE DR

RAMSGATE DR

RAMSGATE DR

RAMSGATE DR

RAMSGATE DR

RAMSGATE DR

RAMSGATE DR

FOX LN

FOX LN

FOX LN

FOX LN

FOX LN

FOX LN

FOX LN

FOX LN

FOX LN

FOX LN

FOX LN

FOX LN

FOX LN

FOX LN

FOX LN

ROMIG LN

ROMIG LN

ROMIG LN

ROMIG LN

ROMIG LN

ROMIG LN

ROMIG LN

ROMIG LN

ROMIG LN

ROMIG LN

ROMIG LN

ROMIG LN

ROMIG LN

WILLOWood TER

WILLOWood TER

WILLOWood TER

WILLOWood TER

WILLOWood TER

WILLOWood TER

WILLOWood TER

WILLOWood TER

WILLOWood TER

WILLOWood TER

WILLOWood TER

WILLOWood TER

BAILEY LN

BAILEY LN

BAILEY LN

BAILEY LN

BAILEY LN

BAILEY LN

BAILEY LN

BAILEY LN

BAILEY LN

BAILEY LN

BAILEY LN

BAILEY LN

BAILEY LN

ELIZABETH LN

ELIZABETH LN

ELIZABETH LN

ELIZABETH LN

ELIZABETH LN

ELIZABETH LN

ELIZABETH LN

ELIZABETH LN

ELIZABETH LN

ELIZABETH LN

ELIZABETH LN

ELIZABETH LN

ELIZABETH LN

